

TECE:

Intelligent housing technology

TECEplanus Radio Control – 9.240.360



Mounting and operating instructions

Start-up procedure

Prior to fitting the radio control to the flipper-type support handle, the batteries enclosed have to be placed in the unit:

- Turn the screw on the rear side of the housing and open the cover. Place the two batteries as marked in the housing.

The volume of the audible beep for acoustic flush acknowledgement can be set only when the housing is open.

- We recommend the works setting - „full“ volume. In order to reduce the volume, turn the controller to the left; by turning the controller to the right the volume is increased.

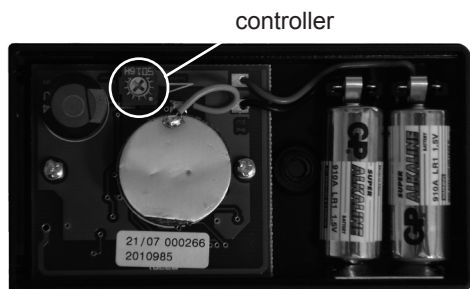

Now close the housing again tightly.

- Please make sure you place the housing lid correctly: A sealing ring has been fitted in the lid, which prevents water from getting inside.
- When screwing down the housing lid, please make sure that the sealing ring makes tight contact to the lock screw.

Mounting

The radio control is supplied with two pre-mounted fastening clamps for screw fastening to the support handles up to a pipe diameter of 33 mm.

- Undo the screw connections of the universal clamps. Subsequently use these two clamps to fasten the radio control to the upper or lower pipe (depending on the support handle)..
- Tighten the screws after you have positioned the radio transmitter.

Depending on the requested position of the transmitter, the radio control can be fitted to the support handle in any position (left-hand or right-hand of the WC).

Programming the radio control

Prior to the first use, the radio transmitter has to be programmed to communicate with the respective radio receiver (component part of the corresponding flushing system). Every receiver has a corresponding push-button as well as an LED for this purpose.

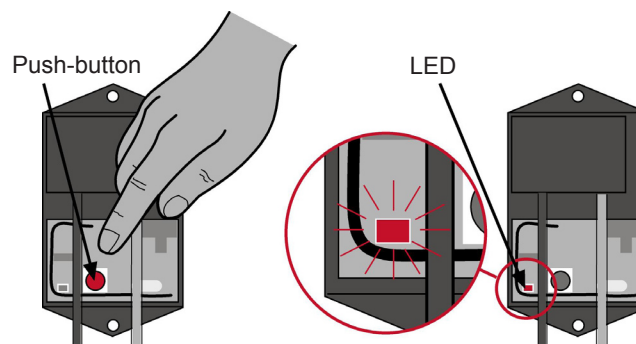

- In order to start the programming process, please press the push-button on the receiver. This action will be acknowledged optically by the receiver by a one-time flash of the LED.
- Now, please press the flush release surface of the radio transmitter within thirty seconds. Three flashes of the LED indicates the successful programming of the radio transmitter

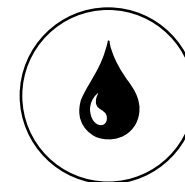

Flushing function

After successful programming, the toilet can be flushed by approaching the release surface (approx. 3 to 5 mm in front of the surface) or by touching this surface. A successful flushing signal will be acoustically acknowledged by the „beep“.

Technical data

Frequency	868,4 MHz
Addressing	Individual 32 bit address, programmable at the receiver
Range	10 m maximum
Functions	Capacitive push-button, acoustic acknowledgement by beep
Release	kapazitiver Taster, akustische Quittierung durch Tastenton
Power supply	3 VDC (2 x alkaline battery LR-1)
Battery life	Approx. 3 years or 100,000 flushes
Housing	ABS housing approx. 85 x 46 x 16 mm
Mounting	By clamps on flipper-type support handle
Colour	Black (RAL 9005)
Degree of protection	IP 54
Compatible WC controls	<div>TECEplanus 9.240.354</div> <div>TECEplanus 9.240.355</div> <div>Geberit 115.867</div> <div>Sanit 03.082.00.0000</div> <div>Viega 462.376</div>